

INSTRUCTIONS FOR FIRE DOOR RETAINER

This electromagnet fire door retainer is intended to hold open fire doors fitted with a suitable closing mechanism. The power supply to this door retainer must be controlled by the building's fire detection system. The door will be held open when power is supplied to the unit and released when power is disconnected. This fire door retainer should only be installed by a technically competent person.

Specifications

Rated Holding Force.....200 newtons.
 Maximum Holding Force.....250 newtons.
 Maximum Cable Size stranded....2.5 mm²,
 single.....4.0 mm²
 Residual Holding Force.....Zero.
 Door closer power size.....3 to 6

Current 24 V dc..... 50 mA,
 230 V ac..... 12 mA.

CE	Stephenson Gobin Ltd Bishop Auckland DL14 0HY England	05					
	1121-CPD-AE0011	EN1155:1997 + A1:2002	3	5	6 3	1	1

Mounting Instructions

- Decide on suitable mounting positions for the magnet and the keeper plate at least 650 mm from the axis of the door hinge. The keeper plate will adjust through a 30° angle to help alignment with the face of the magnet. The black push switch is used to release the door manually and should be easily accessible when the door is retained open.
- Fit the magnet box (1) to the wall or fixed surface. Check that the screw fixings and the mounting surface are strong enough to withstand the holding force of the door retainer.
- Cable entry can be directly through the back face of the box or through the 20 mm entries provided for surface mounted MICC or conduit. All 230 V models must be earthed. Check earth continuity after installation. A readily accessible disconnection device must be incorporated into the fixed wiring. If MICC is used a separate earth lead must be connected from the gland to the earth terminal on the magnet body.
- Fit the lid (2) and secure with the single screw provided.
- Check that the rubber ring (4) is fitted in the base plate (3) before fitting the keeper plate assembly loosely to the door. Adjust the angle to align with the magnet and tighten the mounting screws to lock the plate in place.
- Connect the electrical supply and check the magnet will hold the door open. Check that the door closes when the fire alarm is triggered and when the release switch is pushed.

NOTE: Be sure that the action of the door retainer does not cause the door to become permanently warped and prevent it sealing in the closed position.

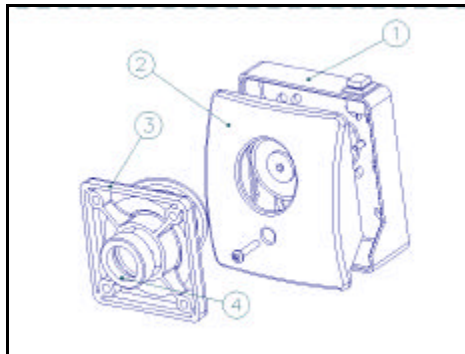

Maintenance

- For optimum holding force, the face of the magnet and keeper plate should be kept clean and free from damage.
- There are no user serviceable parts in this door holder. For repair, return the unit to the manufacturer.
- Fire door holders should be tested weekly as part of the fire-system test procedures.

INSTRUCTIONS FOR FIRE DOOR RETAINER

This electromagnet fire door retainer is intended to hold open fire doors fitted with a suitable closing mechanism. The power supply to this door retainer must be controlled by the building's fire detection system. The door will be held open when power is supplied to the unit and released when power is disconnected. This fire door retainer should only be installed by a technically competent person.

Specifications

Rated Holding Force.....200 newtons.
 Maximum Holding Force.....250 newtons.
 Maximum Cable Size stranded....2.5 mm²,
 single.....4.0 mm²
 Residual Holding Force.....Zero.
 Door closer power size.....3 to 6

Current 24 V dc..... 50 mA,
 230 V ac..... 12 mA.

CE	Stephenson Gobin Ltd Bishop Auckland DL14 0HY England	05					
	1121-CPD-AE0011	EN1155:1997 + A1:2002	3	5	6 3	1	1

Mounting Instructions

- Decide on suitable mounting positions for the magnet and the keeper plate at least 650 mm from the axis of the door hinge. The keeper plate will adjust through a 30° angle to help alignment with the face of the magnet. The black push switch is used to release the door manually and should be easily accessible when the door is retained open.
- Fit the magnet box (1) to the wall or fixed surface. Check that the screw fixings and the mounting surface are strong enough to withstand the holding force of the door retainer.
- Cable entry can be directly through the back face of the box or through the 20 mm entries provided for surface mounted MICC or conduit. All 230 V models must be earthed. Check earth continuity after installation. A readily accessible disconnection device must be incorporated into the fixed wiring. If MICC is used a separate earth lead must be connected from the gland to the earth terminal on the magnet body.
- Fit the lid (2) and secure with the single screw provided.
- Check that the rubber ring (4) is fitted in the base plate (3) before fitting the keeper plate assembly loosely to the door. Adjust the angle to align with the magnet and tighten the mounting screws to lock the plate in place.
- Connect the electrical supply and check the magnet will hold the door open. Check that the door closes when the fire alarm is triggered and when the release switch is pushed.

NOTE: Be sure that the action of the door retainer does not cause the door to become permanently warped and prevent it sealing in the closed position.

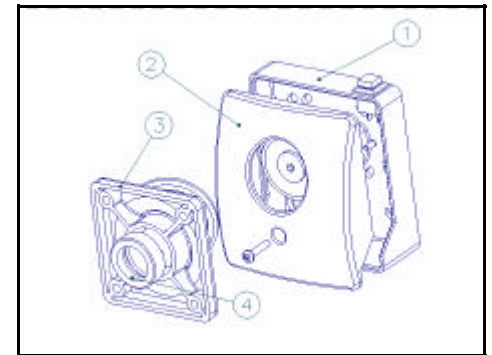

Maintenance

- For optimum holding force, the face of the magnet and keeper plate should be kept clean and free from damage.
- There are no user serviceable parts in this door holder. For repair, return the unit to the manufacturer.
- Fire door holders should be tested weekly as part of the fire-system test procedures.